

En. Mohan Bhardwaj

M.E. (Civil), MIE, MVI
Chartered Engineer

Continental Foundations

- Govt. Approved Valuers (A-15278)
- Regd. Structural Engineers
- PMC Consultants

Office : 1059, Sector 43-B, Chandigarh | E-mail: Contfound@gmail.com

Mob.: 94170-18335, 98885-18335 | Telefax : 0172-4677059

GSTIN : 04AGVPB020AE2Z2

No. ST/14345

Dated: 15-07-2022

TO WHOM IT MAY CONCERN

It is certified that the Building s of "PML SD Public School, Sector: 32C, Chandigarh " has been is inspected by me. The Construction of these Buildings had started in year 1995 and has been constructed upto three Stories. On the visual inspection it has been observed that the same have been constructed with old codal provisions. No structural cracks , deflections have been observed in these buildings. Some of the photographs of building are attached for reference.

As on date the buildings are properly maintained and can be used for running an educational institute.

For M/s Continental Foundations

[Signature]
Principal
Pandit Mohan Lal
Sanatan Dharma Public School
Sector 32-C, Chandigarh-160030

[Signature]
Chairman/Manager
Pandit Mohan Lal
Sanatan Dharma Public School
Sector 32-C, Chandigarh

Approved Structural Consultants : ★ CPWD ★ Chandigarh Administration ★ Haryana Roads & Bridges Corp. Ltd.
★ Haryana Police Housing Corp. Ltd. ★ HSCC ★ Punjab University Chandigarh ★ Panchayati Raj Deptt. (Punjab)
Approved Valuers For : ★ Income Tax Deptt. (GOI) ★ PNB (Punjab) ★ UCO Bank
★ HDFC ★ Chd. House Fed. ★ Haryana Police Housing Co-op Ltd.

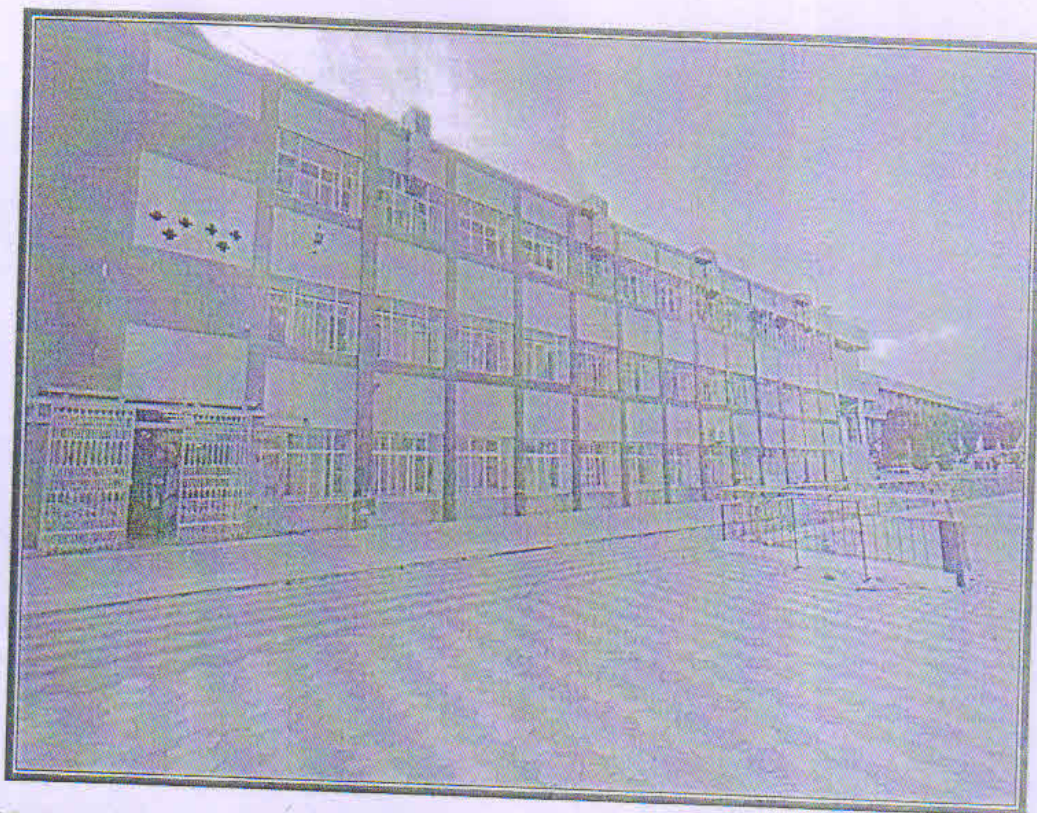

PHOTOGRAPH FROM ASSEMBLY GROUND SIDE OF THE BUILDING

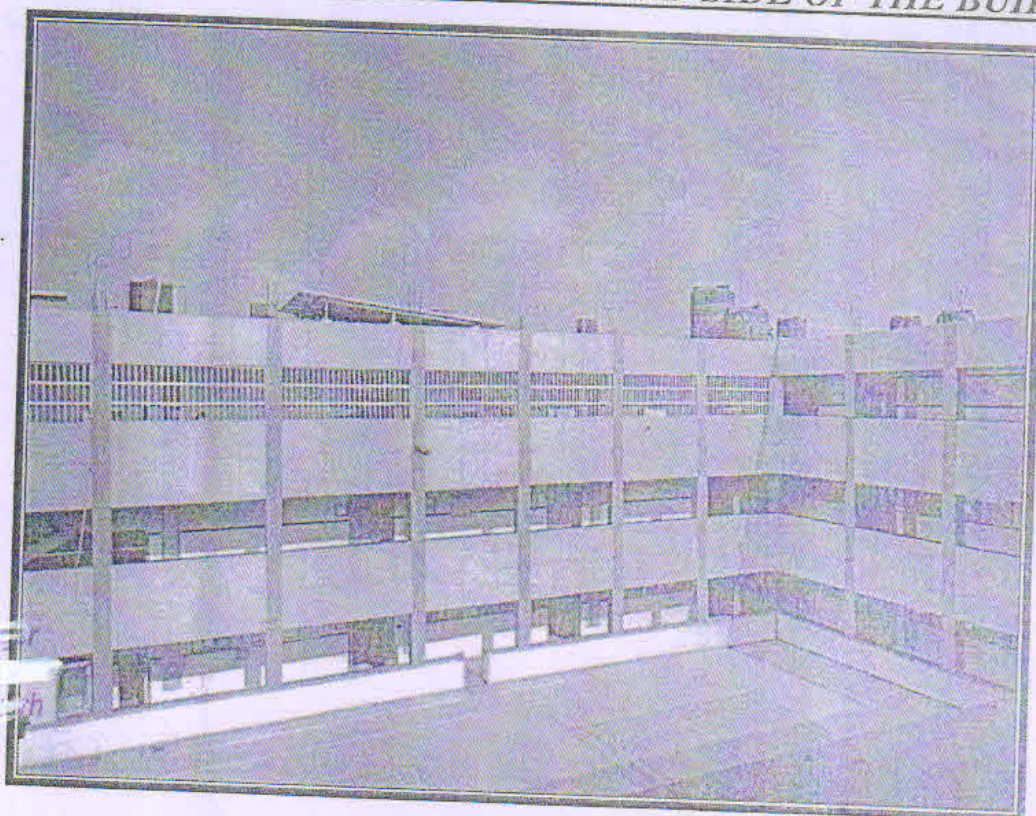

INNER COURTYARD OF THE BUILDING

2

Principal
Pandit Mohan Lal
 Sanatan Dharma Public School
 Sector 32-C, Chandigarh-160030

Chairman-cum-Manager
Pandit Mohan Lal
 Sanatan Dharma Public School
 Sector 32-C, Chandigarh-160030





FRONT ELEVATION OF THE BUILDING

[Signature]
Principal
Pandit Mohan Lal
Sardar Dharma Public School
Sector 32-C, Chandigarh-160030

[Signature]
Chairman-cum-Manager
Pandit Mohan Lal S.D. Public School
Sector 32-C, Chandigarh

